



Rock down



| | |
|--------------|---|
| Item code | 86.SD07.2301.01 |
| Product type | Indoor |
| Category | Surface Downlights |
| Family | Rock |
| Subfamily | Rock down |
| Pictograms | <div><div></div><div><div>220</div><div>240</div><div>v</div></div><div></div><div><div>CRI</div><div>80</div></div><div></div><div><div>50000h</div><div>L80B10</div></div></div> |

| | |
|-------------------------|------------|
| Dimensions | |
| Product dimensions (mm) | Ø320xH57mm |

Scheme

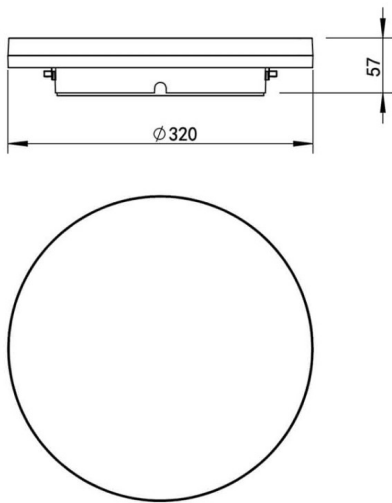

| | |
|----------------------------|----------------|
| Product | |
| Real power (W) | 10/15/20 |
| Real luminous flux (Lm) | 1200/1800/2400 |
| Luminous efficiency (Lm/W) | 120 |
| Beam angle (°) | 105,5º |
| IP | 54 |
| Control gear | On-off |
| Power Factor | >0,9 |
| Colour temperature (K) | 3000/4000/6000 |
| Colour consistency (SDCM) | SDCM<3 |
| CRI | >80 |
| IK | IK10 |